

Monday, October 05, 2020

**LOCATION**

<b>Property Address</b>	2215 E Main St Murfreesboro, TN 37130-5803
<b>Subdivision</b>	
<b>County</b>	Rutherford County, TN

**PROPERTY SUMMARY**

<b>Property Type</b>	Unknown
<b>Land Use</b>	Tax Freeze
<b>Improvement Type</b>	Single Family Residential
<b>Square Feet</b>	1604

**GENERAL PARCEL INFORMATION**

<b>Parcel ID/Tax ID</b>	103C A 029.00
<b>Alternate Parcel ID</b>	103C A 02900 00013103C
<b>Account Number</b>	R0066377
<b>District/Ward</b>	1
<b>2010 Census Trct/Blk</b>	421/1
<b>Assessor Roll Year</b>	2020

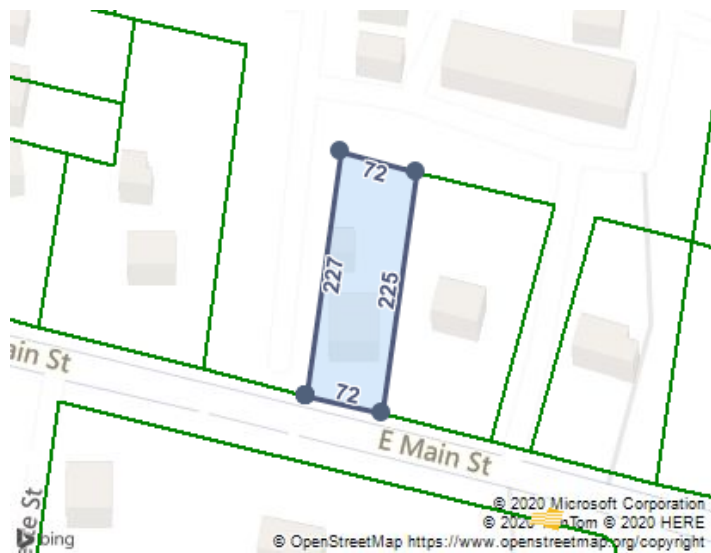

**TAX ASSESSMENT**

Appraisal	Amount	Assessment	Amount	Jurisdiction	Rate
<b>Appraisal Year</b>	2020	<b>Assessment Year</b>	2020	<b>Murfreesboro</b>	1.2894
<b>Appraised Land</b>	\$33,000	<b>Assessed Land</b>	\$8,250	<b>Rutherford</b>	2.2194
<b>Appraised Improvements</b>	\$122,000	<b>Assessed Improvements</b>	\$30,500		
<b>Total Tax Appraisal</b>	\$155,000	<b>Total Assessment</b>	\$38,750		
		<b>Exempt Amount</b>			
		<b>Exempt Reason</b>			

**TAXES**

Tax Year	City Taxes	County Taxes	Total Taxes
2019	\$499.64	\$860.02	\$1,359.66
2018	\$367.89	\$813.52	\$1,181.41
2017	\$348.10	\$773.18	\$1,121.28
2016	\$348.10	\$773.18	\$1,121.28
2014	\$348.10	\$717.41	\$1,065.52
2013	\$337.58	\$681.70	\$1,019.28

**PROPERTY CHARACTERISTICS: BUILDING**

**Building # 1**

<b>Type</b>	Single Family Residential	<b>Condition</b>	Average	<b>Units</b>	1
<b>Year Built</b>	1936	<b>Effective Year</b>	1988	<b>Stories</b>	1
<b>BRs</b>		<b>Baths</b>	F H	<b>Rooms</b>	

Total Sq. Ft. 1,604

<b>Building Square Feet (Living Space)</b>	<b>Building Square Feet (Other)</b>
Base 1604	

**- CONSTRUCTION**

<b>Quality</b> Average	<b>Roof Framing</b> Hip/Gable
<b>Shape</b>	<b>Roof Cover Deck</b> Composition Shingle
<b>Partitions</b>	<b>Cabinet Millwork</b>
<b>Common Wall</b>	<b>Floor Finish</b> Allowance
<b>Foundation</b> 18 Block	<b>Interior Finish</b> Drywall
<b>Floor System</b>	<b>Air Conditioning</b>
<b>Exterior Wall</b> Frame Aluminum	<b>Heat Type</b> Electric Rad
<b>Structural Framing</b>	<b>Bathroom Tile</b>
<b>Fireplace</b>	<b>Plumbing Fixtures</b> 3

**- OTHER**

<b>Occupancy</b>	<b>Building Data Source</b> Inspection
------------------	--

**PROPERTY CHARACTERISTICS: EXTRA FEATURES**

Feature	Size or Description	Year Built	Condition
Porch-Slab Roof	306		
Porch-Slab Roof Ceil	190		
Asph Pav	1327	1982	AVERAGE
Dcu	252	1963	AVERAGE
Dgu	576	1967	AVERAGE
Frpl	1	1934	FAIR
Mh1	272	1960	AVERAGE

**PROPERTY CHARACTERISTICS: LOT**

<b>Land Use</b> Tax Freeze	<b>Lot Dimensions</b> 70 X 225
<b>Block/Lot</b>	<b>Lot Square Feet</b> 43,560
<b>Latitude/Longitude</b> 35.840323°/-86.354017°	<b>Acreage</b> 1

**PROPERTY CHARACTERISTICS: UTILITIES/AREA**

<b>Gas Source</b> Public	<b>Road Type</b> Urban Paved
<b>Electric Source</b> Public	<b>Topography</b> Level
<b>Water Source</b> Public	<b>District Trend</b> Static
<b>Sewer Source</b> Individual	<b>Special School District 1</b>
<b>Zoning Code</b>	<b>Special School District 2</b>
<b>Owner Type</b> Private	

**LEGAL DESCRIPTION**

<b>Subdivision</b>	<b>Plat Book/Page</b>
<b>Block/Lot</b>	<b>District/Ward</b> 1
<b>Description</b> 70 X 225	

**FEMA FLOOD ZONES**

Zone Code	Flood Risk	BFE	Description	FIRM Panel ID	FIRM Panel Eff. Date
-----------	------------	-----	-------------	---------------	----------------------

X	Minimal	Area of minimal flood hazard, usually depicted on FIRMs as 47149C0280H above the 500-year flood level.	01/05/2007
---	---------	---	------------

---